

Draw Like Leonardo

Use the provided guide and a mason jar rim to help you create a Da Vinci-style “Flower of Life” pattern.

You will need:

- [Flower of Life Guide](#) printed on copy paper
- Mason jar rim (regular mouth, 2.75")
- Black permanent marker
- Markers or colored pencils in rainbow colors
- Pencil



Display a picture of a completed [Draw Like Leonardo](#) project to promote this interesting art project.

Directions:

1. Turn the mason jar rim so the top is facedown and make a mark inside the rim with the black marker as shown.

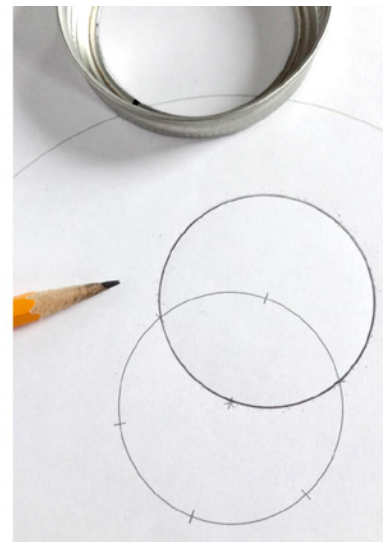

2. Place the rim on the Flower of Life Guide so the black mark is on top of the asterisk in the center of the guide and the rim is aligned with 2 of the hash marks on the circle as shown above. Use a pencil to trace the inside of the rim.

3. Keep the black mark on top of the asterisk and turn the rim to align it with the next set of hash marks, and then trace it again.

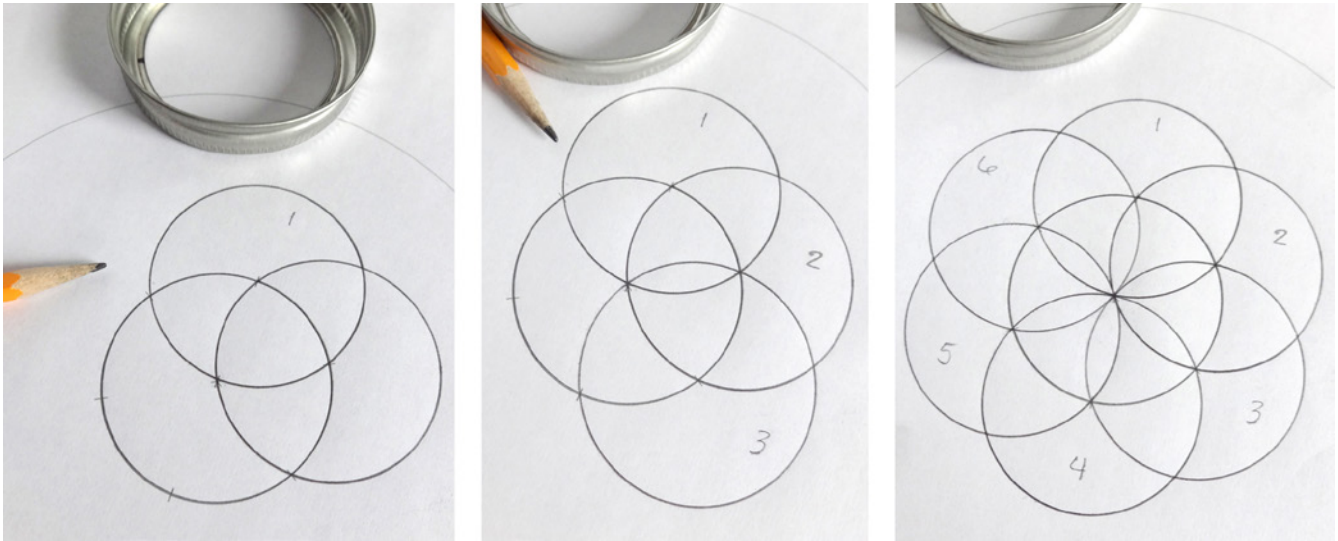

4. Continue moving the rim to the right and tracing circles until you have drawn 6 circles. This design is referred to as the “Seed of Life.” For an easier project, stop here and color the design with pencils or markers. For a more challenging project, continue to the next step.

5. Use red to color the 6 petals in the center as shown.

6. Align the black mark on the rim with the tip of a red petal. Align the inner rim with intersecting circles as shown to the right. Trace a circle. Move the rim right to the next red petal and intersecting circles and trace another circle. Continue doing this until you have traced 6 circles.

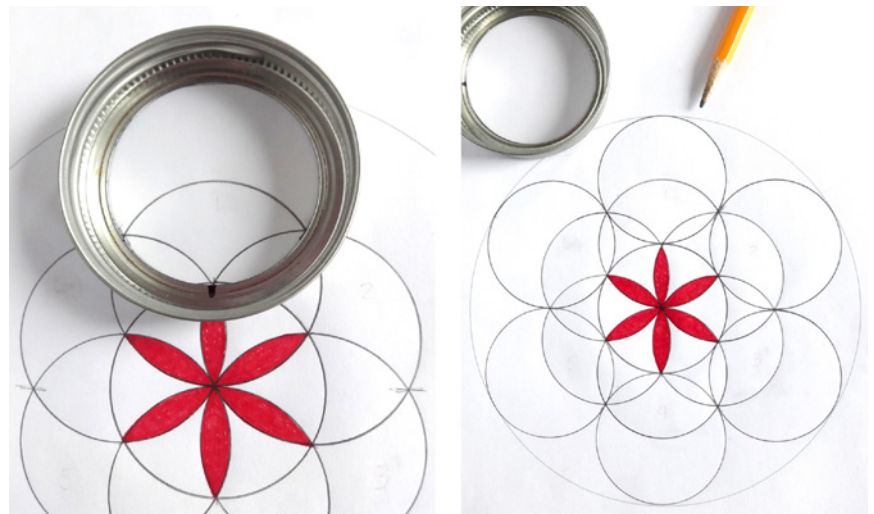

7. Align the black mark and the inner rim with the points of 2 of the red petals. Trace a circle and continue moving the rim to the right until you’ve traced another 6 circles.

8. Use orange to color the 6 petals that circle the red petals. Use yellow to color the 18 petals that extend out from the orange petals.

9. Align the inner rim with the end points of 2 yellow petals as shown to the right. Trace a circle and continue to the right until you've traced 12 circles. Color these petals green.



10. Write an X on the 6 petals that extend out between the green petals as shown in the first photo below.
11. Align the black mark on the rim with the tip of one of the petals with an X. Align the inner rim on circles that intersect to the right and left of the X-petal as shown in the middle photo below.

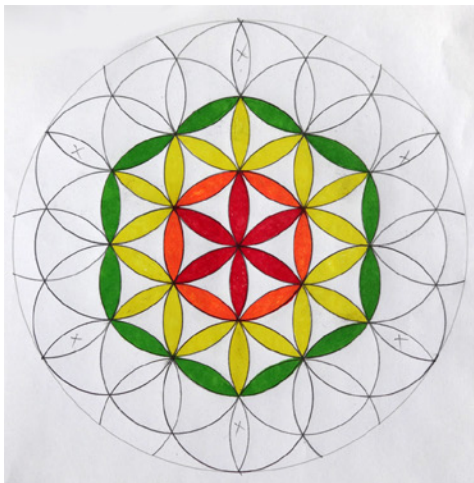

12. Trace a half circle so it connects with the large gray circle printed on the guide. Continue to the right to draw 5 more half circles.
13. Color the 30 petals extending out from the green petals light blue.
14. Continue tracing the rim to make petal shapes between all the light blue petals as shown in the first photo on the next page. Color these petals dark blue.

15. Finish by coloring the remaining white border purple. You've now completed a Flower of Life.

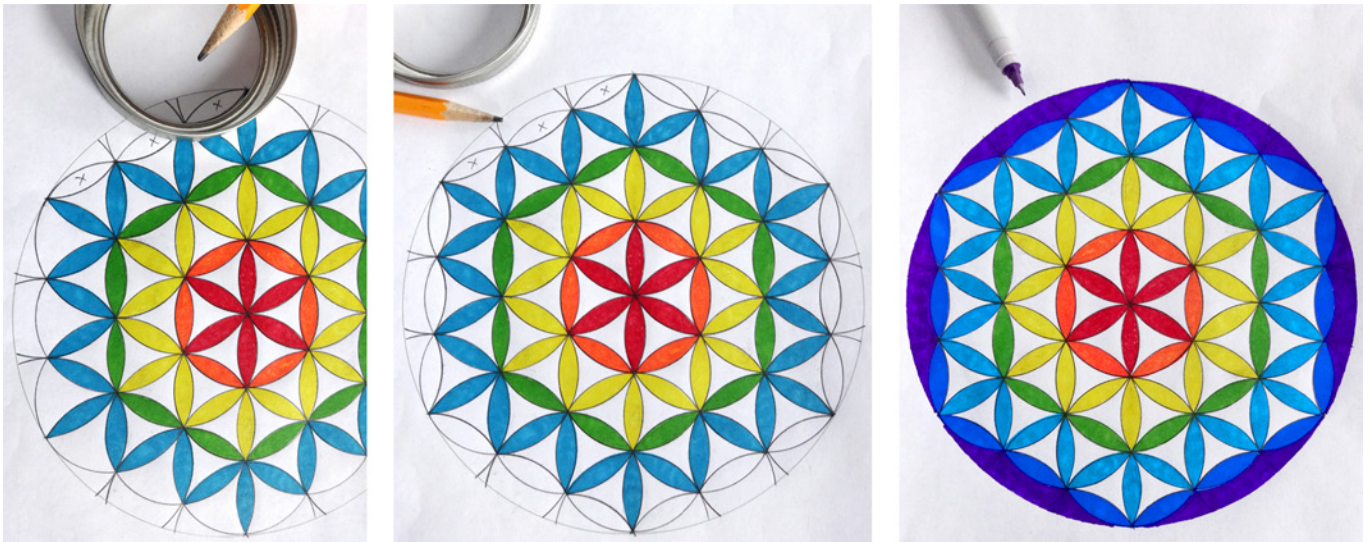

Why is the pattern called the “Flower of Life”?

“Flower of Life” is the modern name for geometric patterns of overlapping circles. Often the points of a triangle are used to measure the exact place where the circles will intersect. Versions of this early form of mathematically based art have been found in artifacts from ancient Greece, Rome, and Islam, as well as in the sketchbooks of Leonardo da Vinci. Today the Flower of Life (and the simpler Seed of Life pattern) is used in quilting, jewelry design, and even tattoo art.

Flower of Life Guide

Print on copy paper.

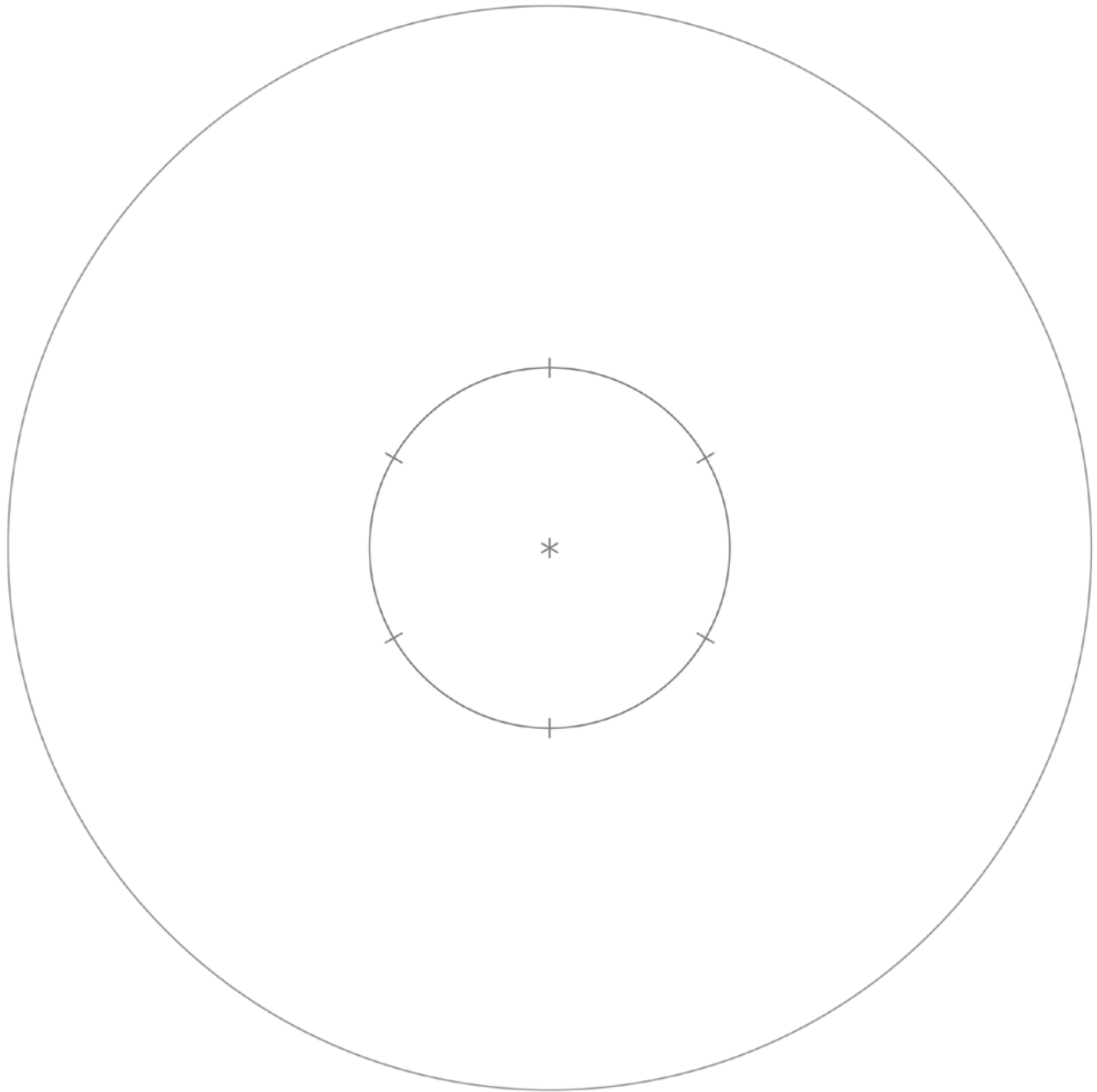

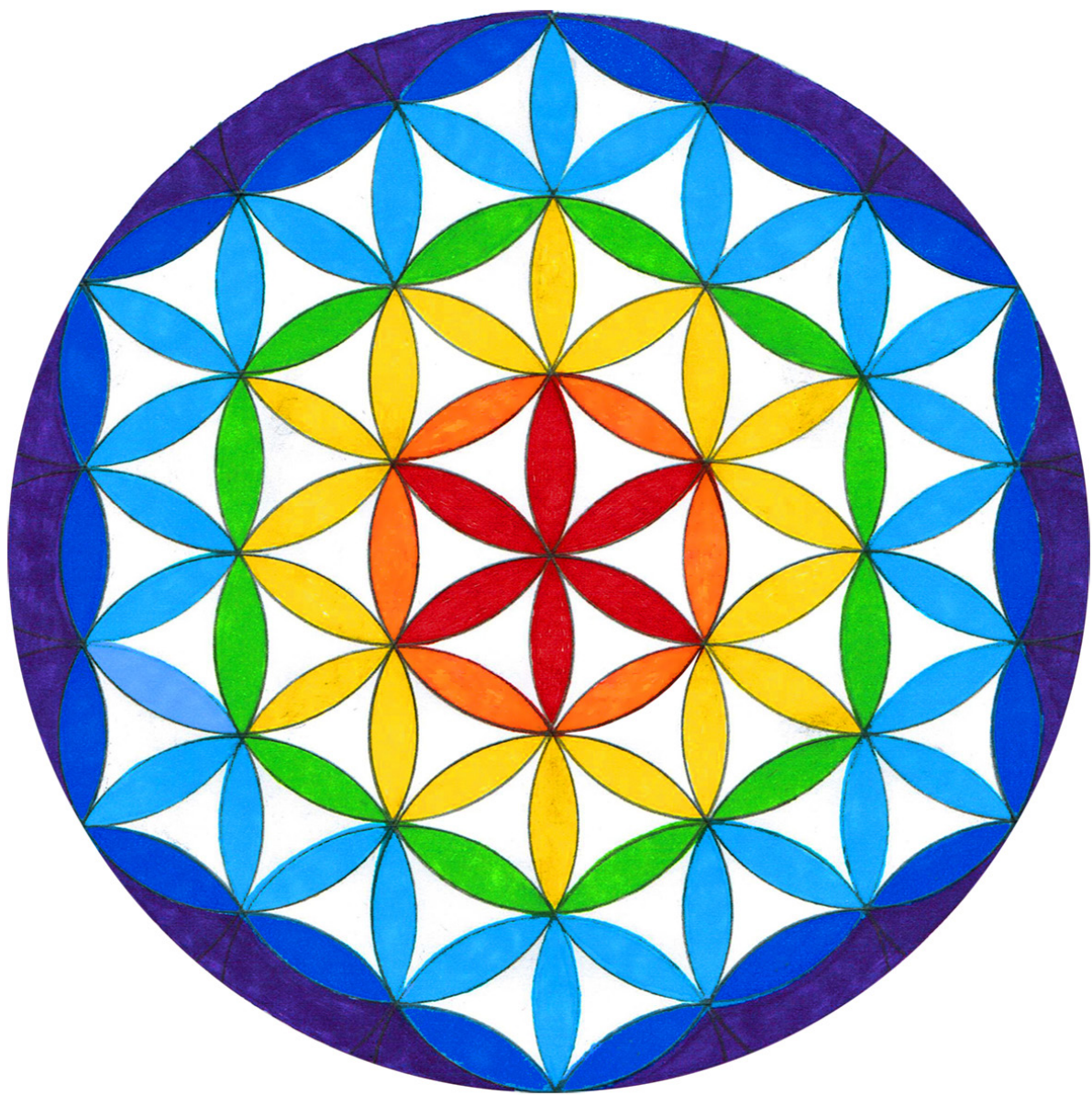

Draw Like Leonardo